

High impact cleaner MeshClean Series 5T2/5T3



Features:

- High degree of effectiveness due to particularly powerful solid stream nozzles
- Suitable for smaller tanks with stubborn dirt
- High surface quality
- Active self-cleaning due to special nozzle geometry
- Especially low maintenance



Series 5T2/5T3



**ATEX version
available on
request**

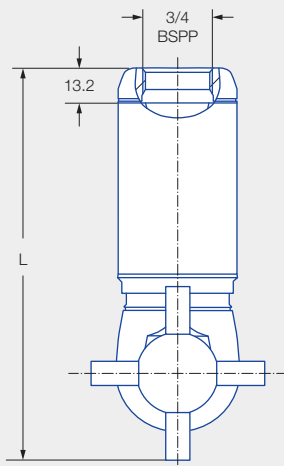

Female thread

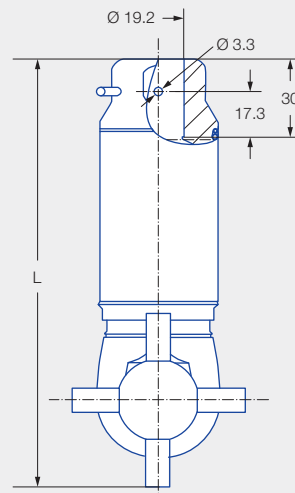

Dimensions of the
slip-on connection according
to ASME-BE (OD-tube)

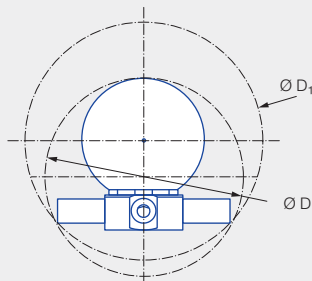

Insertion diameter D_1 and
interference circle diameter D_2
of the threaded connection

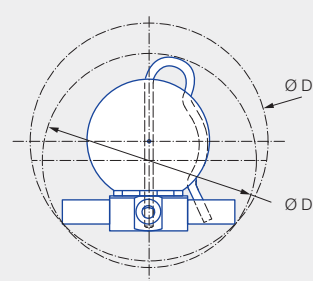

Insertion diameter D_1 and
interference circle diameter D_2
of the slip-on connection





Max. tank diameter [m]	0	3	6	9	12	15	18	21	24	27
-------------------------------	---	---	---	---	----	----	----	----	----	----

Cleaning efficiency class
5

Max. temperature
150 °C

Installation
Operation in every direction is possible

Bearing
Ball bearing

Material
Stainless steel 316L, PTFE, PEEK, EPDM

Recommended operating pressure
5 bar

Filtration
Line strainer with a mesh size of 0.2 mm/80 mesh

Rotation monitoring
Sensor compatible, for information: See page 221

Weight
1.0 kg

Adapter
3/4 BSPP is compatible with HygienicFit

www.lechler.com/de-en/medialibrary/videos-general-industry
Or scan the QR code.



Spray angle	Ordering no.			Narrowest free cross section Ø [mm]	Number, Ø Nozzles [mm]	V̇ water [l/min]			Dimensions [mm]						Max. tank diameter [m]
	Type	Code				p [bar] (p _{max} = 15 bar)			Female thread			Slip-on connection			
		3/4 BSPP	3/4"- Slip-on connection			2.0	5.0	at 40 psi [US gal/min]	L	Ø D ₁	Ø D ₂	L	Ø D ₁	Ø D ₂	
360° 	5T2.849.1Y	AL	TF07	1.75	4 × 1.75	13	20	4	142	68	82	157	77	82	11.5
	5T2.969.1Y	AL	TF07	2.70	4 × 2.70	25	40	8	142	68	82	157	77	82	12.0
	5T3.029.1Y	AL	TF07	3.20	4 × 3.20	35	55	11	142	68	82	157	77	82	12.5
	5T3.089.1Y	AL	TF07	4.00	4 × 4.00	50	79	16	148	74	91	163	82	91	13.0

The maximum tank diameter applies to the recommended operating pressure and is meant as a recommendation only.
The cleaning result is also affected by the type of soiling.

Ordering Type + Code = Ordering no.
example: 5T2.849.1Y + AL = 5T2.849.1Y.AL

