

Jacket cooled submersible pumps for chemically aggressive media

Chromatic CH 250, CH 260

Application

Pump for conveying chemically aggressive domestic waste water such as, for example salt water (up to 15%) from water softening plants, condensate from condensing boilers, waste water from car washing systems, swimming pool water, sea water, brackish water, silage sap and liquid manure. Keeping trenches, shafts and rooms dry. Domestic waste water disposal in industry and trade. Reduction of surface water. Emergency deployment for flooding. A cooling jacket with discharge connector at the top ensures sufficient motor cooling even at low water level (sip operation). Automatic ventilation with additional air vent screw. Removable strainer allows extraction of residual water down to 5 mm. Automatic purging device can be implemented. **DIN EN 12050-2:** Conformity and type-tested and monitored by the LGA. **Installation:** Stationary or mobile. Version with float switch for use as automatic water level controlled drainage pump.

Conveying medium: Chemically aggressive domestic waste water with solid content up to 10 mm grain size.

Temperature of conveying medium: 35°C, briefly up to 60°C

Operating mode: Continuous operation (S1), at medium temperature 36 - 60°C: Intermittent operation (S3 30%).

Construction

Fully submersible pump, consisting of:
Pump: Single stage centrifugal pump with vertical pressure connection and integrated non-return valve.

Impeller: Open multi-channel impeller, spherical clearance 10 mm.

Motor: Pressure watertight, medium-immersed motor. Stainless steel motor housing. Insulation class B, protection type IPX8. Thermal sensor for temperature monitoring in the winding. Connection Cable: H07RN8-F 3G1.

Shaft/Bearing: Generously-proportioned chromium steel motor shaft, permanently-lubricated roller bearing.

Seal: Shaft seal with a combination of dual shaft sealing ring and a mechanical seal.

Conveying capacity

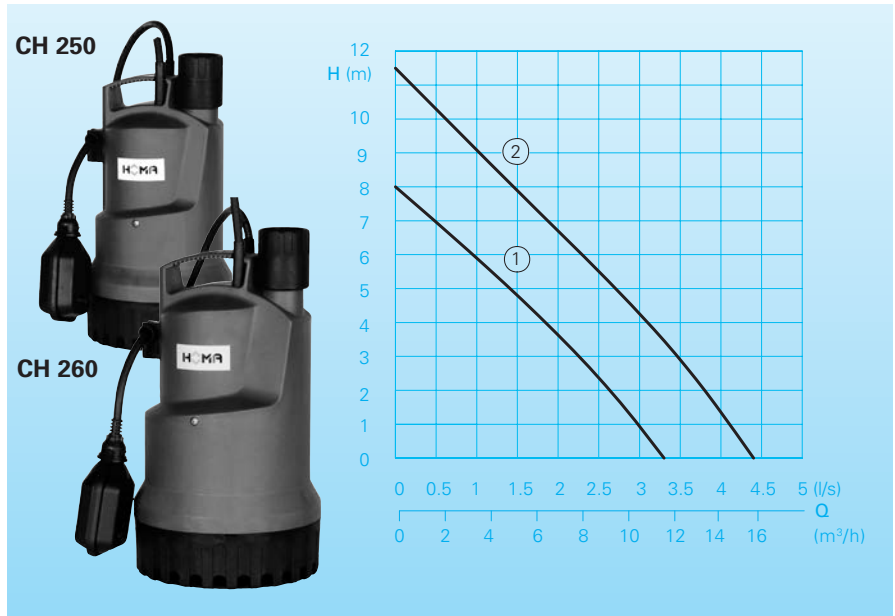

Technical Data

| Curve no. | Pump type | Motor power | | Voltage 50 Hz (V) | Nominal current (A) | Weight (kg) |
|-----------|-------------|---------------------|---------------------|-------------------|---------------------|-------------|
| | | P ₁ (kW) | P ₂ (kW) | | | |
| ① | CH 250 W(A) | 0,55 | 0,26 | 230/1Ph | 2,5 | 5,3 |
| ② | CH 260 W(A) | 0,90 | 0,48 | 230/1Ph | 4,0 | 6,1 |

Speed: 2850 rpm

Pressure connection: G 1 ¼ F

Type A: With automatic float switch HOMA-Nivomatik.

Materials

| | |
|--|----------------------------------|
| Motor housing, motor shaft, screws | Highly-resistant stainless steel |
| Strainer, outer housing, impeller, pressurised lid | Impact-resistant plastic |
| Mechanical seal | SiC/SiC |
| Elastomers | NBR |

Scope of Supply

Pump with twin box G 1 ¼ with integrated non-return valve, sealing ring and hose connection, 10 m connection cable and mains plug.

Type A: With automatic float valve switch HOMA-Nivomatik.

Dimensions and Installation Example (all dimensions in mm)

CH 250

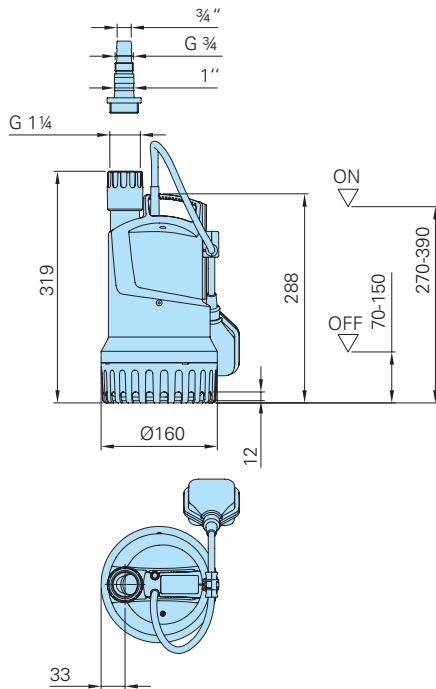

CH 260

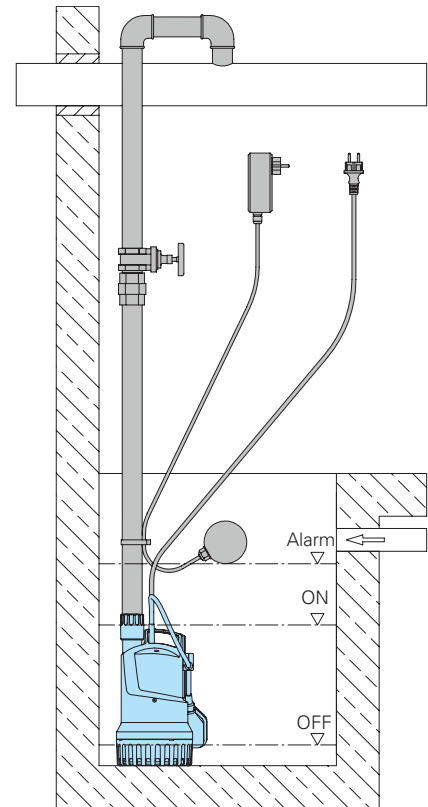
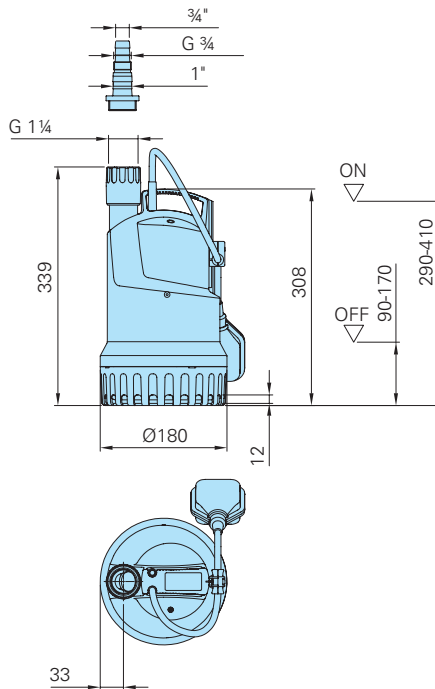

Accessories

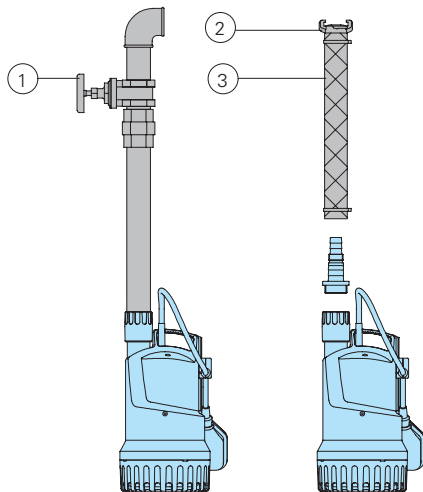

| Description | Size | Part No. |
|--|---------------|-----------|
| ① Gate valve, brass | BSP 1 1/4" F | 2216012 |
| ○ Non-return valve, brass (if no integrated non-return valve fitted) | BSP 1 1/4" F | 2211213 |
| ○ Double nipple, galvanised | BSP 1 1/4" M | 2009011 |
| ② Fixed coupling, brass | BSP 1 1/4" M | 2005413 |
| hose coupling, brass | 1 1/4" | 2003413 |
| | 1" | 2003313 |
| | 3/4" | 2003212 |
| ③ PVC hose, per m | 1 1/4" Ø 30mm | 2621200 |
| | 1" Ø 25 mm | 2621000 |
| | 3/4" Ø 19 mm | 2620700 |
| Plastic spiral hose, per m | 1 1/4" Ø 32mm | 2632030 |
| | 1" Ø 25 mm | 2632025 |
| | 3/4" Ø 19 mm | 2632019 |
| Hose clip | 1 1/4" | 2302330 |
| | 3/4"-1" | 2303252 |
| ○ Return valve, gate valve, fittings of resistant plastic or stainless steel | | on demand |

| Description | Size | Part No. |
|--|------|----------------------|
| ○ Residual current device 2-pin, Fi 16/0.03 A | | 1561160 |
| ○ Mains-dependent alarm control unit AL3 with connector for 9 V rechargeable battery (see below) for operation independent of mains power supply, with built-in signal transmitter for 230 V, 1-phase mains connection | | 1586140 |
| 9V battery for mains-independent alarm | | 1952215 |
| ○ Float valve switch MB, mercury-free, MIN or MAX function, with integrated counterweight | | |
| Cable length | 6 m | 1465706 |
| | 10 m | 1465710 |
| ○ Pump control systems and switching gear for mobile and permanent usage, level recording and monitoring devices | | See HOMA accessories |

HOMA
P U M P T E C H N O L O G Y

HOMA Pumpenfabrik GmbH
P.O. Box 2263, D-53814 Neunk.-Seelscheid
Tel. +49 (0) 22 47/702-0, Fax +49 (0) 22 47/702-44
e-mail: info@homa-pumpen.de
www.homapumpen.com